

No-Mar Pro Model service Instructions: T-pin Collar and Guide Bushing

If servicing the T-Pin assembly, do that **FIRST**.

- 1 - Tilt the machine to the front or side. (Fig. 1)
- 2 - Remove **1/2" Nylock nut** from the bottom of the rear leg.
- 3 - Set machine base back on the ground, PULL THE "T" PIN and lift the Upper Arm assembly out of the machine stand. (Fig. 2)
- 4 - Remove set screws from the existing Stop Collar and slide it off of the Upper Arm assembly (discard).
- 5 - Slide the new Stop Collar onto the Upper Arm assembly at least 26" and secure by temporarily tightening two of the set screws.
- 6 - Replace the Upper Arm assembly into the machine.
- 7 - Tilt the machine forward and replace the 1/2" Nylock nut from step 2 (Fig. 1) - tightening the nut, then backing it off one quarter turn.
- 8 - Set the Upper Arm assembly to point to front/center twelve o'clock, with the center post centered over the dog block assembly. (Fig. 3)
- 9 - Loosen the set screws from the replacement collar and position it as shown (Fig. 4), allowing the 'T' pin to set into its locking hole, and tightening set-screws E, F and G, only.
- 10 - Re-tighten the four bronze alignment bolts (Fig 5) in this order:

(be sure to maintain the orientation of the upper arm assembly to 12 O' Clock, with the center post centered over the dog block assembly)

- A) - Tighten bolt A until the space between the collar and the "T" pin assembly is 1/8" or less
- B) - Tighten bolt B until it is 'snug' to the upper arm assembly while ensuring the assembly is centered 'front to back'
- C) - Tighten bolt C and D until they are 'snug' to the upper arm assembly. The upper arm assembly should move freely, but snugly.

NOTE: These will affect the centering of the center post over the Frame arms. Use the rear bolt to move the post to the right and the front bolt to move it to the left. This must be done with the T-Pin engaged in the Stop collar indexing hole. Snug bolts with less than 1 ft. lb of torque. Tighten Bronze stop nuts to 1 ft. lb. Inspect bolts regularly for tightness. Failure to maintain Bronze guide bolts can result in damage to T-Pin Indexing Feature.

CAUTION: The upper Arm assembly will be free from the machine base when this bolt is removed. DO NOT HOLD THE MACHINE BY THE UPPER ARM ASSEMBLY!

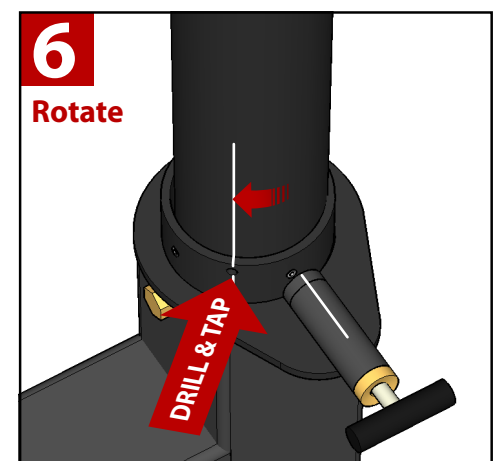
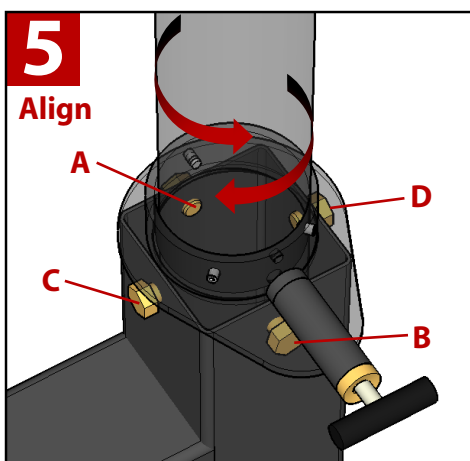
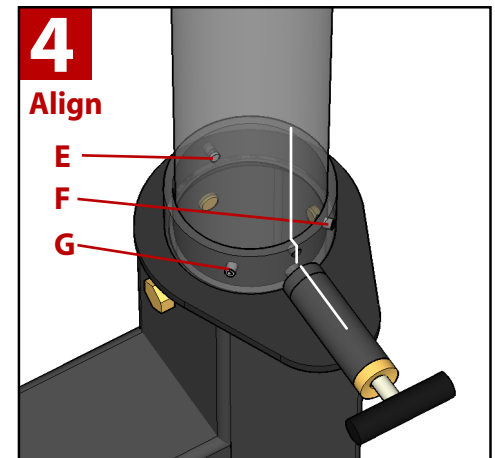
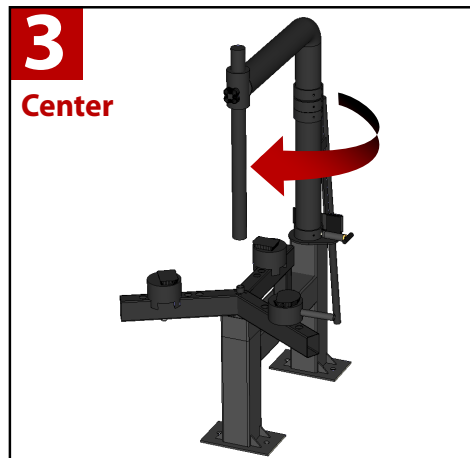
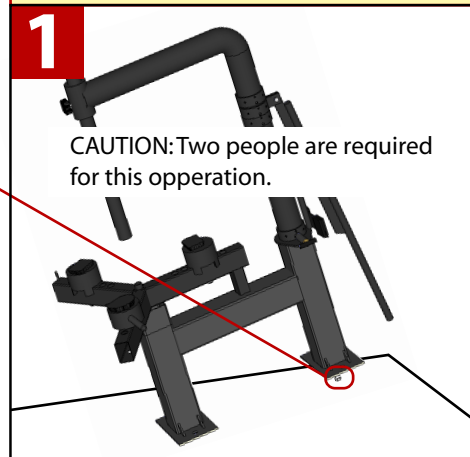

11 - Pull the 'T' pin and rotate the Upper Arm assembly approximately 45° allowing access to the 4ths set screw, as shown in Fig. 6.

12 Using the provided drill bit, drill through the existing hole, and into the Upper Arm Assembly (Fig 6).

13 - Using the Provided 5/16" -18 tap, gently thread the tap into the existing hole, and through the hole you just drilled (Fig 7). Reverse the tap 1/4 turn for every full turn of thread cutting.

14 - Once the threads are cut, and all debris are removed from the hole, insert the 5/16"-18 x 3/8" set screw (provided) (Fig 8) with a coating of Lock-Tight (provided).

Re-attach your machine to the floor and it is ready for use.

