

1

- Push the plunger in the body.
- Grip the smooth rod with pliers
- Unscrew the knob by rotating counterclockwise, when looking directly at the top of the knob

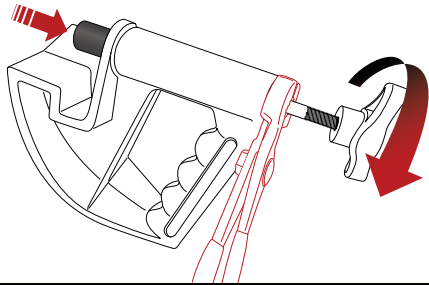

2

- Remove the PLUNGER with SHAFT and SPRING. **KEEP THIS PART!**
- **KEEP THE KNOB!**
- Discard the old handle



XtraHand Clamp Body Replacement

3

- Insert the PLUNGER with SPRING into the NEW HANDLE

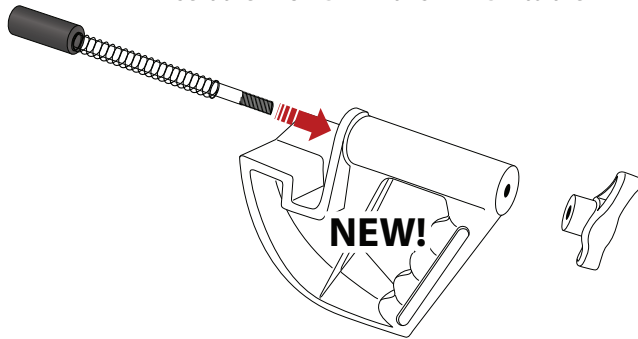

4

**Do Not Force!
Hand Tighten Only!**

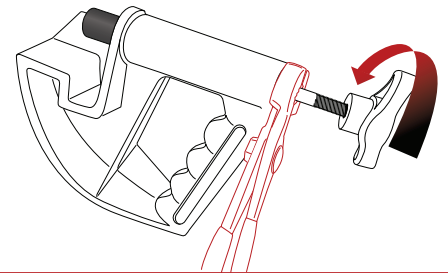

Use



Use the XtraHand Clamp to push the tire down into the relief valley of the rim. This creates more 'room' on the opposite side of the tire, making it easier to get the bead of the tire over the edge of the rim.

3 XtraHand Clamps can be used to compress the sidewall of a tire, making it easier to insert into the locking blocks on a No-Mar tirechanger.



NoMarTireChanger.com

REMOVE

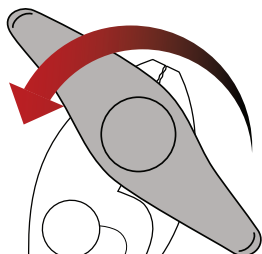

INSTALL

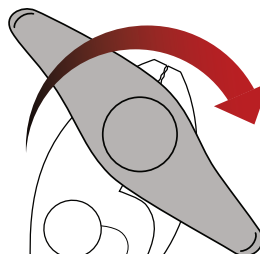

Tools Required

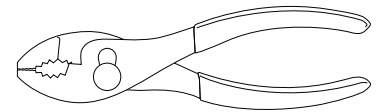

Pliers